

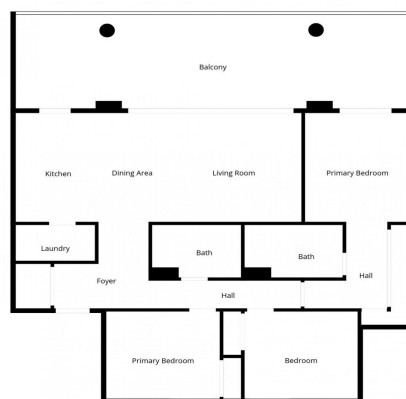

Middle Floor Apartment for sale in Benahavís, Benahavís

945,000 €

Reference: R5209564 Bedrooms: 3 Bathrooms: 2 Build Size: 159m² Terrace: 43m²



Floor Plan Created By Cubicasa App. Measurements Deemed Highly Reliable But Not Guaranteed.





Costa del Sol, Benahavís

Nestled within the tranquil and secure community of La Reserva del Alcuzcuz, this elegant middle-floor apartment offers breathtaking 180-degree panoramic views that stretch across the lush valley and, on clear days, all the way to the distant shores of Morocco. The spacious, covered terrace invites you to unwind under the warm Andalusian sun, and with its southwest orientation, you can enjoy the most unforgettable sunsets.

Inside, the apartment is in impeccable condition, having been used only occasionally. It features three bedrooms and two bathrooms, including an ensuite in the master bedroom. The layout flows naturally, with an open-plan kitchen and attached laundry room. There is ample storage throughout, along with an additional private storage room. The property also includes a garage space, with the option to rent another. A tourist license is already in place—ideal for those considering investment or rental opportunities.

The gated community is meticulously maintained and offers residents a sense of peace and exclusivity. Its mature landscaped gardens are thoughtfully designed to evoke different parts of the world. Residents also have access to two generous pools open all year round.

Located just moments from nature trails and cozy local cafés, the apartment is only a short drive from the renowned restaurants of Benahavís Pueblo and the beaches of San Pedro. It perfectly combines tranquility with convenience.

With keys on hand, viewings are highly flexible—allowing you to experience for yourself the exceptional beauty this home has to offer.



Features:

Features

Covered Terrace
Lift
Near Transport
Storage Room
Ensuite Bathroom
Marble Flooring
Fitted Wardrobes
WiFi

Views

Sea
Panoramic
Garden
Golf

Pool

Communal

Parking

Private

Orientation

South West

Setting

Close To Golf
Close To Shops
Close To Town
Close To Schools

Garden

Communal

Category

Luxury

Climate Control

Air Conditioning
Central Heating
U/F/H Bathrooms

Condition

Excellent

Security

Gated Complex
Alarm System
Electric Blinds